

Scottish Borders Council
Town And Country
Planning (Scotland) Act
1997

REFUSED

subject to the
requirements of the
associated Decision
Notice

KEY:
LAND OUTLINED IN RED = APPLICATION SITE
LAND OUTLINED IN BLUE = OWNED BY APPLICANT

Ordnance Survey License No. - 100022432

Location Plan

Scale: 1:1250



CLIENT: Mrs C Redpath			<p align="center">© <i>Richard Amos Ltd.</i></p> <p align="center">Chartered Architectural and Building Surveying Services</p> <p>2 Golden Square, Duns, Berwickshire, TD11 3AW, X Tel: (01361) 882599, Fax: (01361) 882577, E-Mail: ra@richardamosltd.co.uk</p> <p><small>Registered Office 2 Golden Square, Duns, Berwickshire, TD11 3AW. Registered in Scotland, Company No. 240332 V.A.T. Reg. No. 502 4656 71</small></p>	
PROJECT: Proposed New Dwellinghouse at Plot 5 Hume Holdings, Hume				
DRAWN: TD	SCALE: 1:1250	DATE: 28/04/2021	A4	
TITLE: Location Plan			DRAWING NO: 19/B472/PL01	
DO NOT SCALE FROM THIS DRAWING. These drawings are subject to copyright laws: © Richard Amos Ltd			This drawing is for Planning Purposes Only	

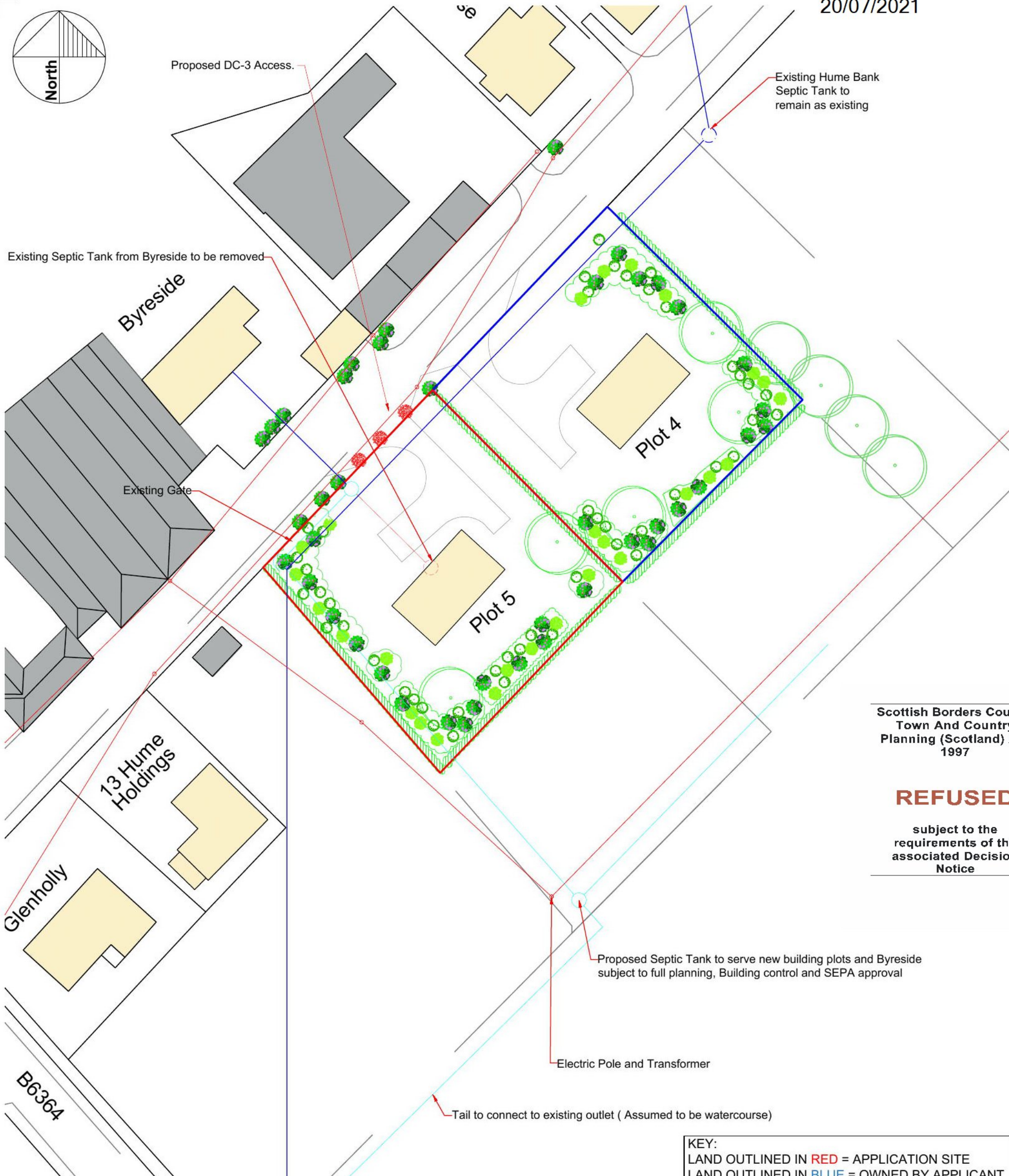
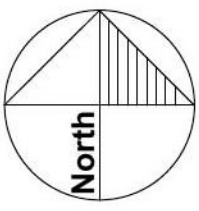

Scottish Borders Council
Town And Country
Planning (Scotland) Act
1997

REFUSED

subject to the
requirements of the
associated Decision
Notice

KEY:
LAND OUTLINED IN RED = APPLICATION SITE
LAND OUTLINED IN BLUE = OWNED BY APPLICANT
Ordnance Survey License No. - 100022432

Site Plan
Scale: 1:500
0m 10m 20m 30m 40m 50m 60m

- KEY**
- Existing Drainage
 - Proposed Drainage
 - Overhead Electrical Cables

CLIENT: Mrs C Redpath			
PROJECT: Proposed New Dwellinghouse at Plot 5 Hume Holdings, Hume			
DRAWN: TD	SCALE: 1:500	DATE: 28/04/2021	A3

Richard Amos Ltd.
Chartered Architectural and Building
Surveying Services

2 Golden Square, Duns, Berwickshire, TD11 3AW,
Tel: (01361) 882599, Fax: (01361) 882577,
E-Mail: ra@richardamosltd.co.uk

Registered Office 2 Golden Square, Duns, Berwickshire, TD11 3AW.
Registered in Scotland, Company No. 240332 V.A.T. Reg. No. 502 4656 71

TITLE: Proposed Site Plan DRAWING NO: 19/B472/PL03